





-  Suitable for DC/DC conversions in notebook computers, PDAs and plantops
-  Small size and high performance with low profile
-  Unshielded and self-leaded design for pick and place handling
-  Inductance range from 10 to 1000 micro H
-  RoHS compliant



**ELECTRICAL SPECIFICATION @ 25°C**

Part Number	Inductance <sup>2</sup> L (uH ± 20%)	DCR (m Ω) Max	SRF (MHz) Typ	Isat <sup>3</sup> (A)	Irms <sup>4</sup> (A)	Marking (XYYY)
UIS3308M-103F	10	110	35	2.4	2.0	M103
UIS3308M-153F	15	150	33	2.0	1.5	M153
UIS3308M-223F	22	230	25	1.6	1.3	M223
UIS3308M-333F	33	300	19	1.4	1.1	M333
UIS3308M-473F	47	390	14	1.0	0.8	M473
UIS3308M-683F	68	660	12	0.9	0.7	M683
UIS3308M-104F	100	840	10	0.7	0.6	M104
UIS3308M-154F	150	1200	8	0.6	0.5	M154
UIS3308M-224F	220	1900	6	0.5	0.4	M224
UIS3308M-334F	330	2700	5	0.4	0.3	M334
UIS3308M-474F	470	4000	4	0.3	0.2	M474
UIS3308M-684F	680	5300	3	0.2	0.1	M684
UIS3308M-105F	1000	8400	2.5	0.1	0.05	M105

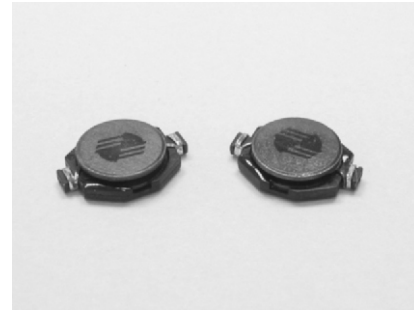
**Notes:**

1. Ordering Information: UIS3308a - bbbFc.  
 UIS3308 = Product Type.  
 a = Tolerance of Inductance (M= ±20%).  
 bbb = Inductance value in uH (i.e. 473 = 47uH; 474 = 470uH; 105 = 1000uH).  
 F = Internal Control Code.  
 c = Packaging Code (T = Tape & Reel Packaging in 13 inch).
2. Inductance is tested at 100kHz, 0.1Vrms.
3. Inductance drops 10% typical at Isat.
4. T=30°C rise typical at Iirms.
5. Operating temperature range: -40°C to +125°C.
6. The part temperature (ambient temperature + temperature rise) should not exceed the upper limit of the operating temperature under worst case operating conditions. Circuit design, component placement, PWB trace size and thickness, airflow and other cooling provisions all affect the part temperature. Part temperature should be verified in the end application.



**MECHANICAL DIMENSIONS**

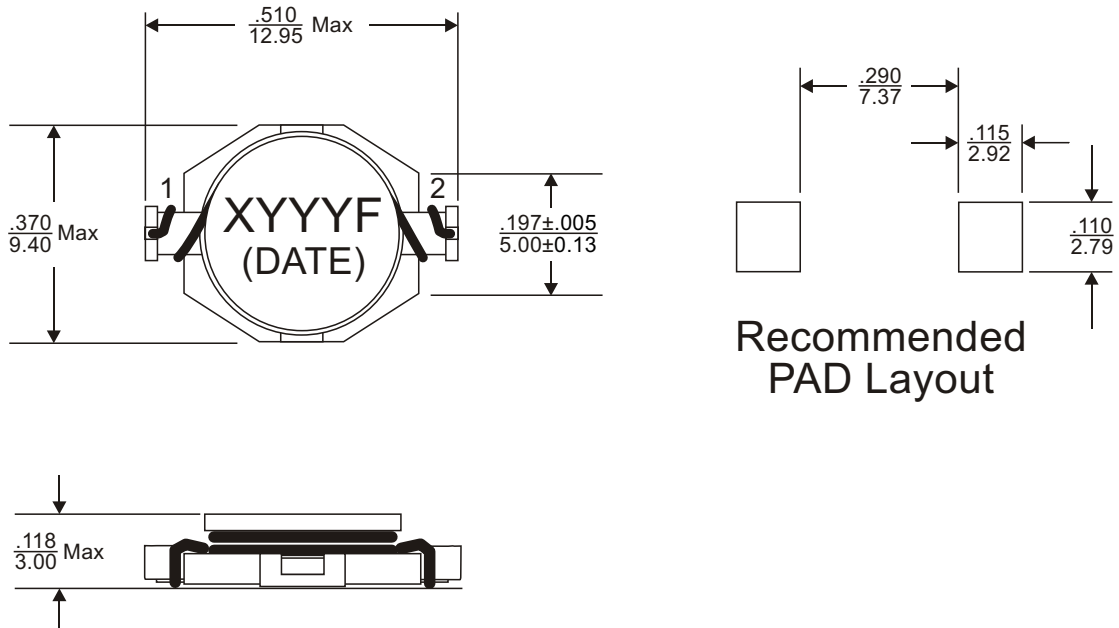

**Notes:**

- 7. All dimensions are specified in  $\frac{\text{inches}}{\text{mm}}$  with higher precedence in inches.
- 8. Unless otherwise specified, all tolerances are  $\pm 0.010$  /  $\pm 0.25$ .

Weight (in gram)	: 0.8 typ.
Tape & Reel	: 1400 / reel

**SCHEMATIC**

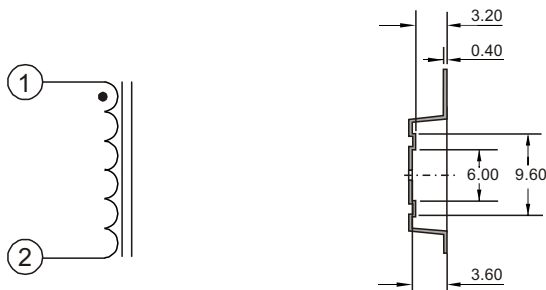

**PACKAGING**

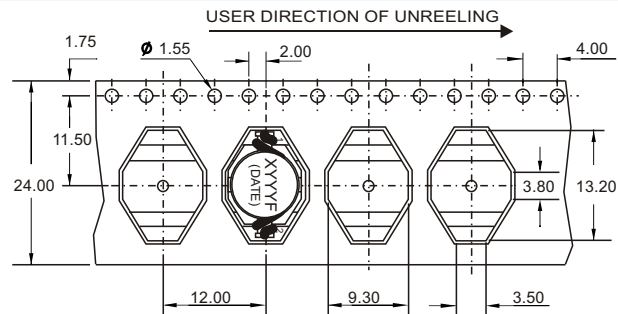

**FOR MORE INFORMATION, PLEASE CONTACT**

**HEADQUARTER**  
1/F., Harbour View 1, No.12 Science Park East Avenue,  
Phase II, Hong Kong Science Park, Shatin, N.T.  
Hong Kong  
Tel: (852) 2954 3333 Fax: (852) 2954 3304  
Email: eempl@eleceltek.com  
Website: <http://www.eleceltek.com> / [www.eemagnetic.com](http://www.eemagnetic.com)

Information herein is for reference only and subject to change without notice. It does not constitute any representation, warranty or commitment of the company in respect of the products in any aspect. All logos, brands and product names mentioned herein are trademarks or registered trademarks of their respective owners. The company does not assume any liability arising out of the application or use of any product or circuit described herein. Copyrights 2009, E & E Magnetic Products Limited.