

BPSS Series

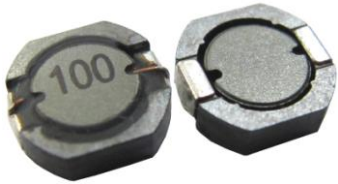

The BPSS Series is designed for low profile type with low RDC and large current. The magnetic shielding supports high – density mounting. This series also provides working – frequency up to 1MHz.

Features

- RoHS compliant
- Low Rdc and high saturation current for portable DC to DC converter line
- High magnetic shielding construction provides high resolution for EMC protection
- Support lead-free soldering

Applications

- Notebook PC
- Set top box
- LCD TV
- LCD displays
- Portable communication device
- DC/DC converters

Product Identification

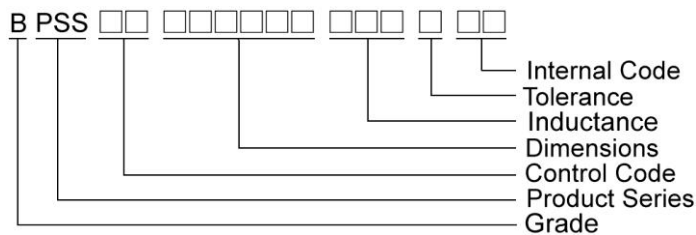

Shape and Dimensions

FIG 1

FIG 2

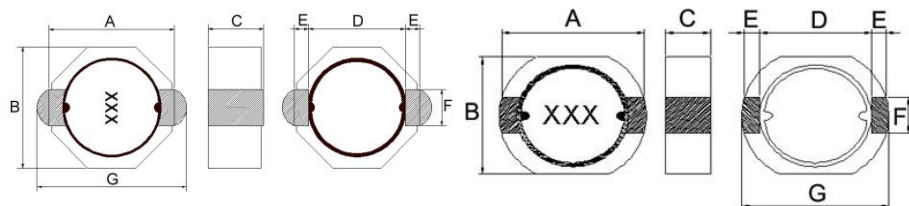

Recommended Pattern

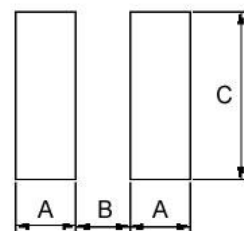

Dimensions in mm

TYPE	Shape and Dimensions								Recommended Pattern		
	FIG	A	B	C	D	E	F	G	A	B	C
BPSS00050522	1	5.2±0.3	5.0±0.3	2.2Max	4.0	0.6	1.5	6.2Max	1.5	3.2	1.5
BPSS00080725	2	7.5±0.3	7.4±0.3	2.5Max	5.6	1.2	2.5	8.7Max	1.5	5.4	2.8
BPSS00080740	2	7.5±0.3	7.4±0.3	4.0Max	5.6	1.2	2.5	9.2Max	1.5	5.4	2.8

SMD Shielded Power Inductors – BPSS Series

Standard Specifications

Part Number	Inductance (uH)	Tolerance (±%)	Test Frequency (kHz)	RDC (mΩ) Max	Isat (A)	Irms (A)
BPSS000505221R2□00	1.2	30	100	25	4.3	3.43
BPSS000505221R8□00	1.8	30	100	32	3.6	3.12
BPSS000505223R3□00	3.3	30	100	54	2.5	2.68
BPSS000505224R7□00	4.7	30	100	81	2.0	2.18
BPSS00050522100□00	10	20,30	100	160	1.4	1.51
BPSS00050522220□00	22	20,30	100	320	0.9	1.02
BPSS00050522330□00	33	20,30	100	490	0.77	0.80

Note: When ordering, please specify tolerance code. Tolerance: M=±20% , T=±30%

- Operating temperature range - 40°C ~ 105°C(Including self - temperature rise)
- Isat for Inductance drop 30% from its value without current
- I rms for a 40°C temperature rise from 25°C ambient with current
- Measure Equipment :

L : HP4284A.+Aglient 16334A , 100kHz/ 1V

RDC : Chroma 16502

Isat : HP4284A+HP42841A or WK3260B+WK3265B

I rms : Agilent 6641 SYSTEM DC POWER SUPPLY

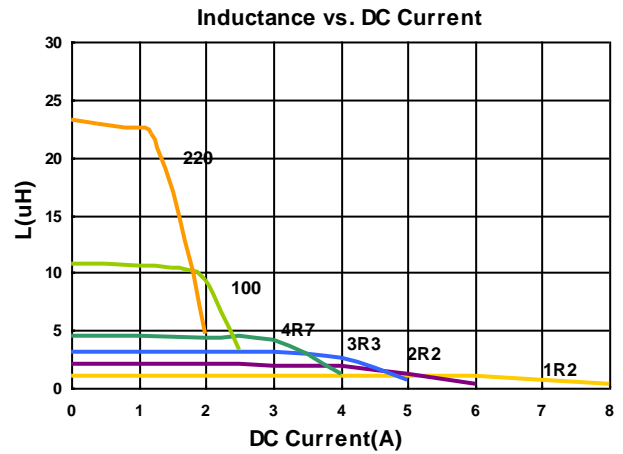
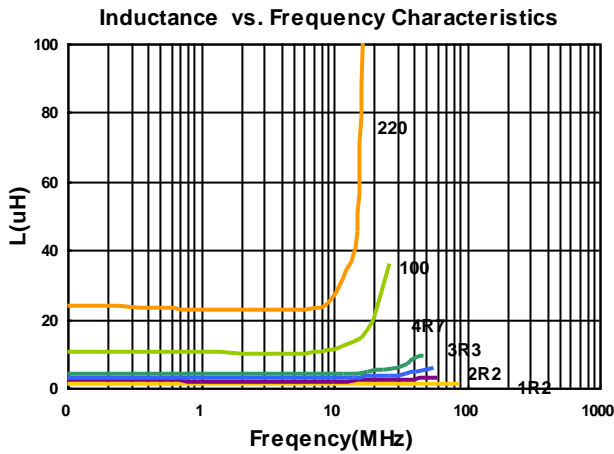

SMD Shielded Power Inductors – BPSS Series

Standard Specifications

Part Number	Inductance (uH)	Tolerance (±%)	Test Frequency (kHz)	RDC (mΩ) Max	Isat (A)	Irms (A)
BPSS000807251R0□00	1.0	30	100	14.28	8.3	6.22
BPSS000807251R5□00	1.5	30	100	19.70	7.2	5.00
BPSS000807252R2□00	2.2	30	100	24.09	5.4	4.40
BPSS000807253R3□00	3.3	30	100	41.20	4.4	3.70
BPSS000807254R7□00	4.7	30	100	49.70	4.0	3.20
BPSS000807255R6□00	5.6	20,30	100	58.90	3.9	2.90
BPSS000807256R8□00	6.8	20,30	100	66.30	3.5	2.70
BPSS00080725100□00	10	20,30	100	92.40	2.8	1.90
BPSS00080725150□00	15	20,30	100	170.0	2.3	1.70
BPSS00080725220□00	22	20,30	100	210.0	1.5	1.52
BPSS00080725330□00	33	20,30	100	320.0	1.4	1.10
BPSS00080725470□00	47	20,30	100	490.0	1.2	0.95

Note: When ordering, please specify tolerance code. Tolerance: M=±20%, T=±30%

- Operating temperature range - 40°C ~ 105°C(Including self - temperature rise)
- Isat for Inductance drop 30% from its value without current
- I rms for a 40°C temperature rise from 25°C ambient with current
- Measure Equipment :

L : HP4284A.+Aglient 16334A , 100kHz/ 1V

RDC : Chroma 16502

Isat : HP4284A+HP42841A or WK3260B+WK3265B

I rms : Agilent 6641 SYSTEM DC POWER SUPPLY

Inductance vs. Frequency Characteristics

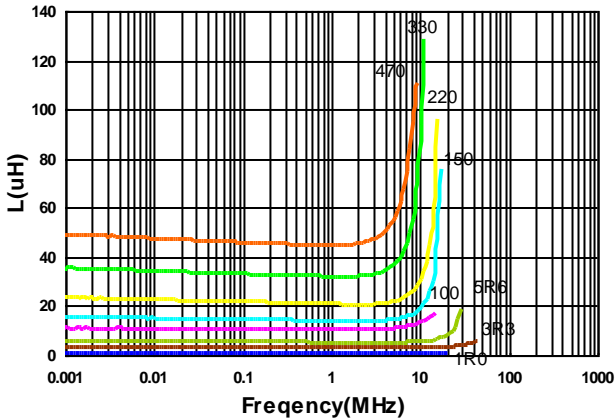

Inductance vs. DC Current

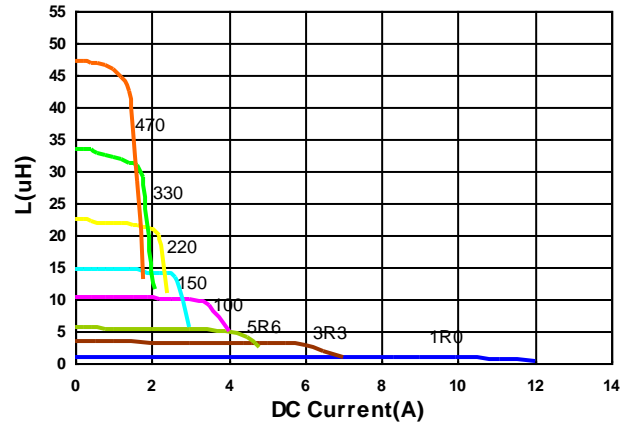

SMD Shielded Power Inductors – BPSS Series

Standard Specifications

Part Number	Inductance (uH)	Tolerance (±%)	Test Frequency (kHz)	RDC (mΩ) Max	Isat(A) Max(Typ)	Irms (A)
BPSS000807401R0□00	1.0	30	100	6.38	(8.0)12	9.00
BPSS000807401R5□00	1.5	30	100	8.64	(7.0)10	8.00
BPSS000807401R8□00	1.8	30	100	9.60	(6.5)8.6	7.92
BPSS000807402R5□00	2.5	30	100	13.6	(4.8)7.2	7.40
BPSS000807403R3□00	3.3	30	100	17.8	(3.9)6.8	6.70
BPSS000807404R7□00	4.7	20,30	100	26.6	(3.5)4.6	4.90
BPSS000807405R6□00	5.6	20,30	100	29.0	(3.3)4.1	4.60
BPSS000807406R8□00	6.8	20,30	100	34.0	(3.2)3.9	3.90
BPSS00080740100□00	10	20,30	100	55.6	(2.5)3.4	3.25
BPSS00080740150□00	15	20,30	100	74.4	(2.1)3.0	2.70
BPSS00080740220□00	22	20,30	100	98.1	(1.7)2.4	2.40
BPSS00080740330□00	33	20,30	100	140	(1.4)2.0	1.90
BPSS00080740470□00	47	20,30	100	217	(1.2)1.7	1.48
BPSS00080740560□00	56	20,30	100	260	(1.0)1.5	1.33
BPSS00080740680□00	68	20,30	100	310	(0.95)1.36	1.20
BPSS00080740820□00	82	20,30	100	360	(0.9)1.20	1.12
BPSS00080740101□00	100	20,30	100	480	(0.85)1.12	0.95
BPSS00080740121□00	120	20,30	100	560	(0.75)1.00	0.89
BPSS00080740151□00	150	20,30	100	710	(0.65)0.92	0.82

Note: When ordering, please specify tolerance code. Tolerance: M=±20% , T=±30%

- Operating temperature range - 40°C ~ 105°C(Including self - temperature rise)
- Isat for Inductance drop 30% from its value without current
- I rms for a 40°C temperature rise from 25°C ambient with current
- Measure Equipment :
 L : HP4284A.+Agilent 16334A , 100kHz/ 1V
 RDC : Chroma 16502
 Isat : HP4284A+HP42841A or WK3260B+WK3265B
 I rms : Agilent 6641 SYSTEM DC POWER SUPPLY

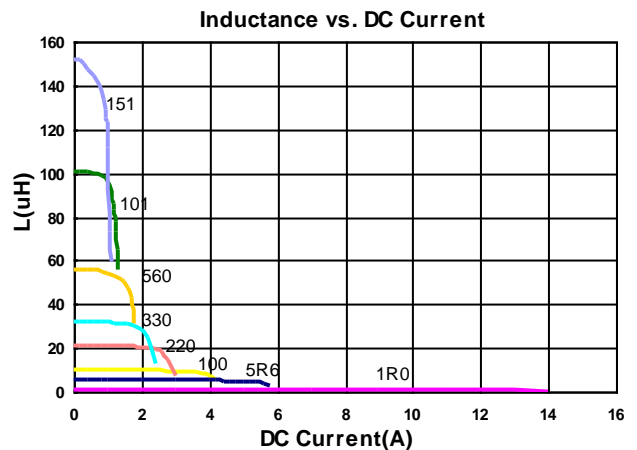
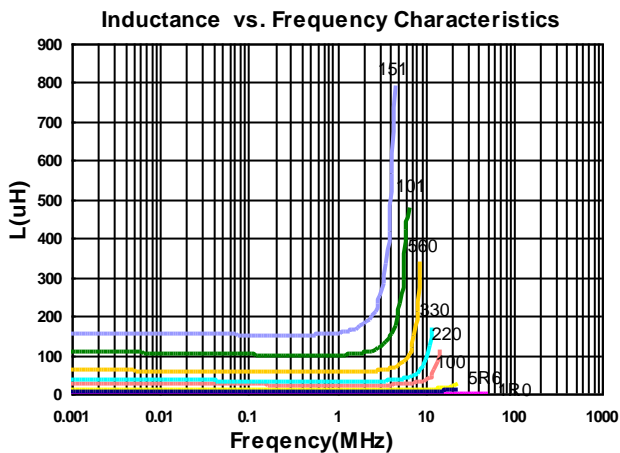

SMD Shielded Power Inductors – BPSS Series

Packaging Specifications

Tape Dimensions

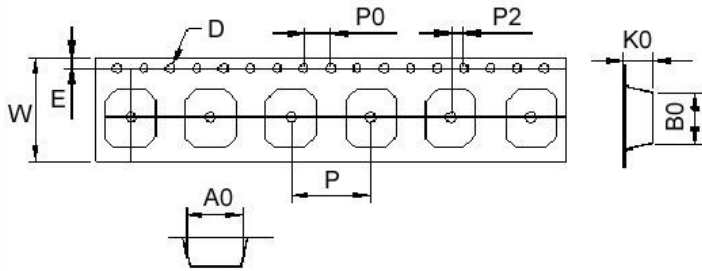

Tape Material

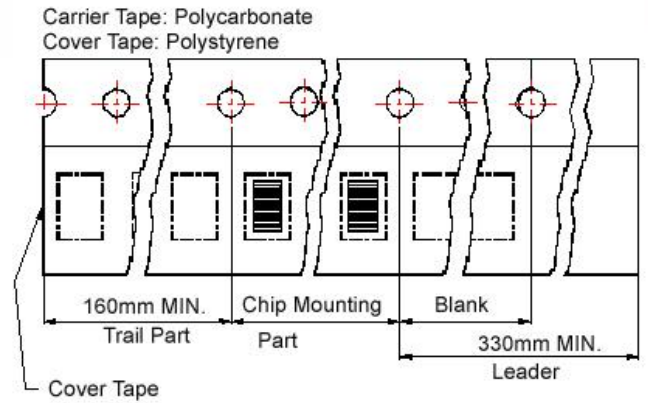

Reel Dimensions

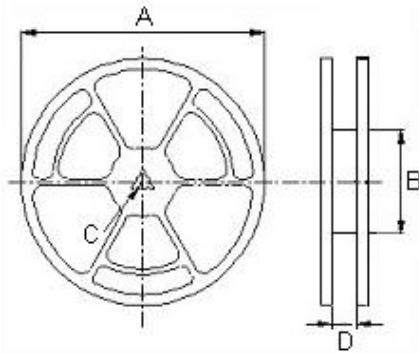

Dimensions in mm

TYPE	Tape Dimensions									Reel Dimensions				Quantity
	A0	B0	K0	D	E	W	P	P0	P2	A	B	C	D	PCS / REEL
BPSS00050522	5.3	6.20	2.4	1.55	1.75	12	8	4	2	330	100	13	13.4	2000
BPSS00080725	7.6	8.65	2.8	1.55	1.75	16	12	4	2	330	100	13	16	1500
BPSS00080740	7.6	9.0	4.3	1.55	1.75	16	12	4	2	330	100	13	16	1000