

Chip Inductor AWHH Series

**Automotive
AEC-Q200**

RoHS Compliant
Halogen Free
REACH Compliant



- RF
Circuit
- Unshield
- Wire
Wound
- Ceramic
- High
Q

Part Numbering

A	WHH	00	161108	10N	H	00
Grade	Series Name	Control Code	Dimensions Code (mm)	Inductance (nH)	Tolerance	
			161108 1.6x1.12x0.82	3N3 3.3 10N 10	H ±3% J ±5%	

This specification applies to Wire Wound Chip Inductors for Automotive Electronics based on AEC-Q200 except for Power train and Safety.

Chip Inductor AWHH Series

Automotive
AEC-Q200

AWHH00161108 Type

■ Dimensions

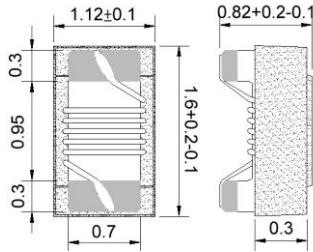

unit:mm

■ Recommended Land Pattern

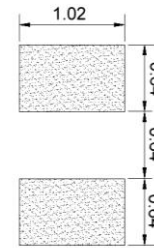

unit:mm

■ Electrical Characteristics

Part No.	Inductance (nH)	L/Q Test		Q Typ.	SRF (GHz)Typ.	RDC (Ω)Max.	I _{rms} (mA)Max.	Tolerance
		Freq. (MHz)						
AWHH001611083N3□00	3.3	250/250		36	9.6	0.034	1900	5,3
AWHH001611083N6□00	3.6	250/250		28	9.7	0.04	1900	5,3
AWHH001611085N1□00	5.1	250/250		38	8.9	0.042	1700	5,3
AWHH001611085N6□00	5.6	250/250		35	6.6	0.042	1700	5,3
AWHH001611086N0□00	6	250/250		49	6	0.042	1700	5,3
AWHH001611088N2□00	8.2	250/250		40	5.9	0.054	1400	5,3
AWHH001611088N7□00	8.7	250/250		46	5.5	0.054	1400	5,3
AWHH001611089N1□00	9.1	250/250		40	5.1	0.052	1400	5,3
AWHH001611089N5□00	9.5	250/250		42	4.9	0.054	1400	5,3
AWHH0016110810N□00	10	250/250		44	4.3	0.054	1400	5,3
AWHH0016110812N□00	12	250/250		40	4.1	0.088	1100	5,3
AWHH0016110818N□00	18	250/250		45	3.3	0.082	1200	5,3

Note: When ordering, please specify tolerance code. Tolerance: H=±3% / J=±5%

- Operating temperature range - 40°C ~ 125°C(Including self - temperature rise)
- I_{rms} for a 15°C temperature rise from 25°C ambient.
- Measure Equipment:
L & Q: Agilent E4991A+Agilent HP16197A
SRF: Agilent E5071C
RDC: Chroma 16502
I_{rms}: HP4284A+HP42841A/HP4285A+HP42841A

AWHH00161108 Type

■ Characteristics Graph

Inductance vs. Frequency Characteristics

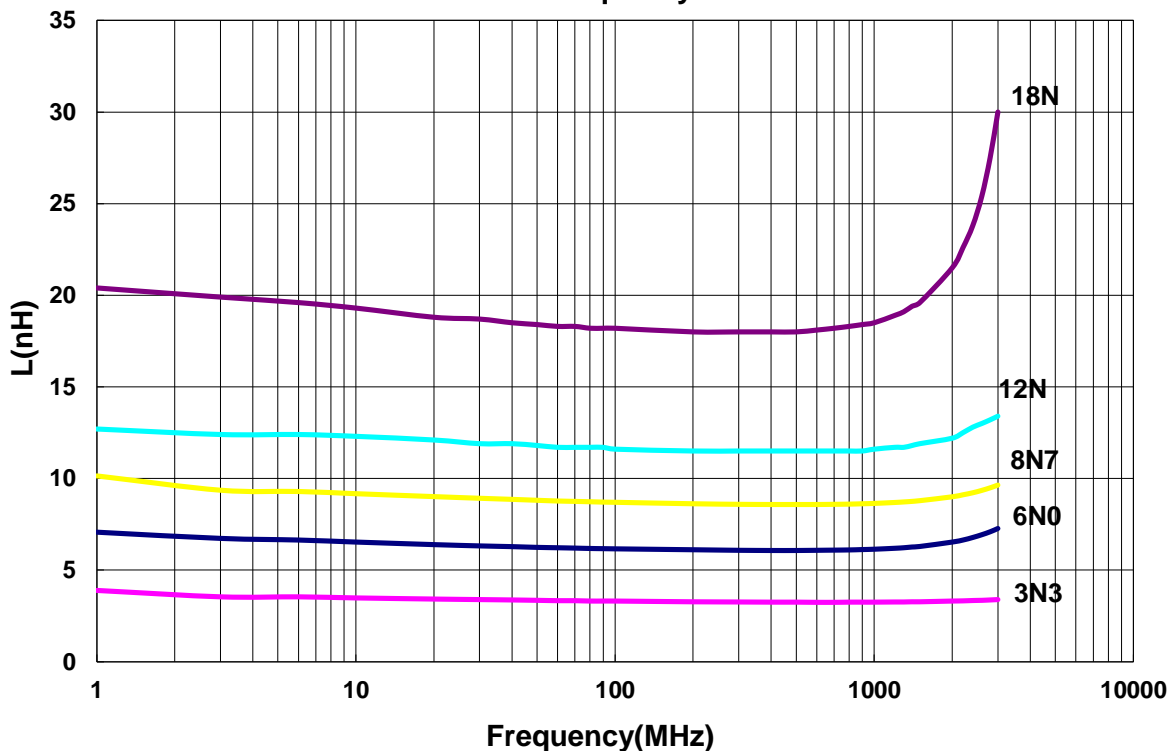

Q vs. Frequency Characteristics

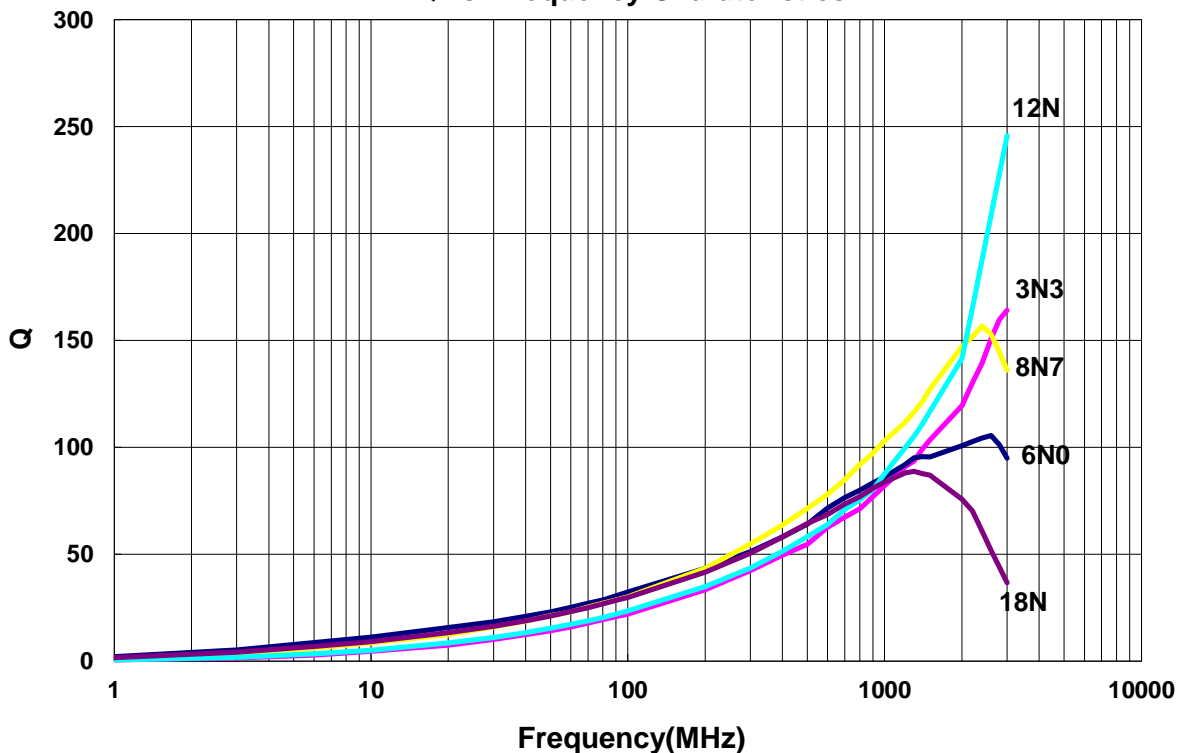

Chip Inductor AWHH Series

Automotive
AEC-Q200

■ Packaging

Tape Dimensions

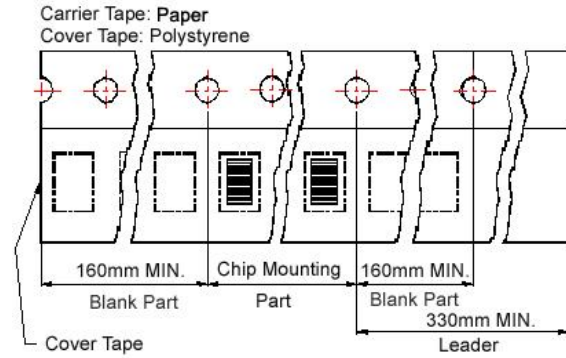
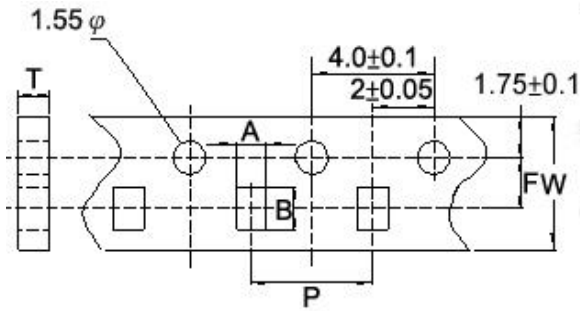

Reel Dimensions

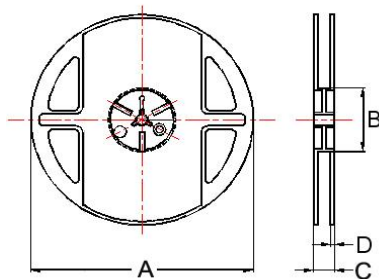

Dimensions in mm

TYPE	Tape Dimensions						Reel Dimensions				Quantity PCS / Reel
	A	B	T	W	P	F	A	B	C	D	
AWHH00161108	1.25	1.90	1.05	8	4	3.5	178	60	12	1.5	4000