

ROB74Type
ROB75Type

- * Surface mounting type.
- * High mounting stability.
- * Comparatively large rated current and high inductance.
- * Use high performance ferrite core.
- * Density design, small size, low cost.



Construction

Unit : (m/m)

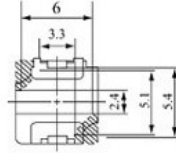
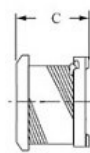
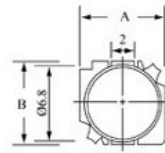

Land patterns

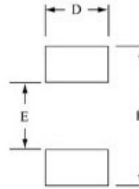

Type	A(MAX)	B(MAX)	C(MAX)	D	E	F	G	H	I
ROB74	7.6MAX.	7.6MAX.	4.1MAX.	3	4.4	8.8			
ROB75	7.6MAX.	7.6MAX.	5.1MAX.	3	4.4	8.8			

[Print] [Close]

Electrical Specification

Unit:(m/m)

Parts No.	Lo (μ H)	Test Freq. (KHz)	Inductance Tolerance %	DC Resistance Spec () max.	Inductance Decrease Current (A) max.
ROB74-1R0M	1.0	100	$\pm 20\%$	0.022	2.88
ROB74-1R5M	1.5	100	$\pm 20\%$	0.026	2.67
ROB74-2R2M	2.2	100	$\pm 20\%$	0.032	2.40
ROB74-3R3M	3.3	100	$\pm 20\%$	0.041	2.08
ROB74-4R7M	4.7	100	$\pm 20\%$	0.049	1.92
ROB74-6R8M	6.8	100	$\pm 20\%$	0.067	1.60
ROB74-100M	10	100	$\pm 20\%$	0.085	1.41
ROB74-120M	12	100	$\pm 20\%$	0.100	1.28
ROB74-150M	15	100	$\pm 20\%$	0.130	1.12
ROB74-180M	18	100	$\pm 20\%$	0.160	1.00
ROB74-220M	22	100	$\pm 20\%$	0.180	0.93
ROB74-270M	27	100	$\pm 20\%$	0.240	0.80
ROB74-330M	33	100	$\pm 20\%$	0.290	0.72
ROB74-390M	39	100	$\pm 20\%$	0.340	0.66
ROB74-470M	47	100	$\pm 20\%$	0.410	0.59
ROB74-560M	56	100	$\pm 20\%$	0.480	0.55
ROB74-680M	68	100	$\pm 20\%$	0.600	0.49
ROB74-820M	82	100	$\pm 20\%$	0.710	0.44
ROB74-101M	100	100	$\pm 20\%$	0.950	0.38

1. The operating temperature range is -25 °C to +85 °C
2. IDC : The current of inductance drop 10%.

Electrical Specification

Unit:(m/m)

Parts No.	Lo (μ H)	Test Freq. (KHz)	Inductance Tolerance %	DC Resistance Spec () max.	Inductance Decrease Current (A) max.
ROB75-1R0M	1.0	100	$\pm 20\%$	0.023	2.80
ROB75-1R5M	1.5	100	$\pm 20\%$	0.028	2.59
ROB75-2R2M	2.2	100	$\pm 20\%$	0.032	2.38
ROB75-3R3M	3.3	100	$\pm 20\%$	0.038	2.14
ROB75-4R7M	4.7	100	$\pm 20\%$	0.049	1.96
ROB75-6R8M	6.8	100	$\pm 20\%$	0.060	1.79
ROB75-100M	10	100	$\pm 20\%$	0.070	1.63
ROB75-120M	12	100	$\pm 20\%$	0.080	1.42
ROB75-150M	15	100	$\pm 20\%$	0.090	1.33
ROB75-180M	18	100	$\pm 20\%$	0.100	1.15
ROB75-220M	22	100	$\pm 20\%$	0.120	1.09
ROB75-270M	27	100	$\pm 20\%$	0.140	0.91
ROB75-330M	33	100	$\pm 20\%$	0.160	0.84
ROB75-390M	39	100	$\pm 20\%$	0.190	0.80
ROB75-470M	47	100	$\pm 20\%$	0.220	0.75
ROB75-560M	56	100	$\pm 20\%$	0.290	0.64
ROB75-680M	68	100	$\pm 20\%$	0.340	0.60
ROB75-820M	82	100	$\pm 20\%$	0.460	0.57
ROB75-101M	100	100	$\pm 20\%$	0.550	0.50
ROB75-121M	120	100	$\pm 20\%$	0.670	0.47
ROB75-151M	150	100	$\pm 20\%$	0.900	0.40
ROB75-181M	180	100	$\pm 20\%$	1.050	0.33
ROB75-221M	220	100	$\pm 20\%$	1.350	0.31
ROB75-271M	270	100	$\pm 20\%$	1.550	0.27
ROB75-331M	330	100	$\pm 20\%$	2.050	0.27
ROB75-391M	390	100	$\pm 20\%$	2.300	0.25
ROB75-471M	470	100	$\pm 20\%$	2.600	0.22

1. The operating temperature range is -25 °C to +85 °C
2. IDC: The current of inductance drop 10%.