

**Power Inductor APSL Series**

**Automotive  
AEC-Q200**

RoHS Compliant  
Halogen Free  
REACH Compliant



Power Circuit
Unshield
Wire Wound
Ferrite

**Part Numbering**

A	PSL	00	130952	1R0	M	00
Grade	Series Name	Control Code	Dimensions Code (mm)	Inductance (uH)	Tolerance	Internal Code
			130952 12.95x9.4x5.21	R47 0.47	M ±20%	
			130911 12.95x9.4x11.43	1R0 1.0	T ±30%	
				101 100		

This specification applies to Power Inductors for Automotive Electronics based on AEC-Q200 except for Power train and Safety.

**Power Inductor APSL Series**

**Automotive  
AEC-Q200**

**APSL00130952 Type**

**■ Dimensions**

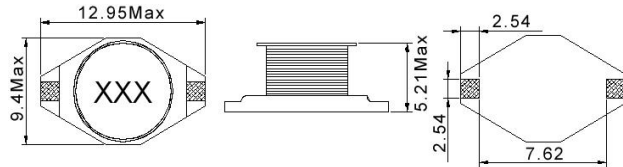

unit:mm

**■ Recommended Land Pattern**

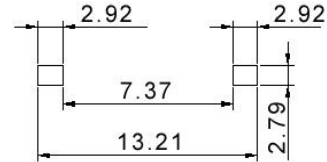

unit:mm

**■ Electrical Characteristics**

Part No.	Inductance (uH)	Test Freq.	RDC (Ω)Max.	Isat (A)	Irms (A)	SRF (MHz)Typ.	Tolerance (±%)	Marking
APSL001309521R0□00	1	100 kHz,0.1 V	0.009	9	6.8	100	20	1R0
APSL001309521R5□00	1.5	100 kHz,0.1 V	0.010	8	6.4	90	20	1R5
APSL001309522R2□00	2.2	100 kHz,0.1 V	0.012	7	6.1	80	20	2R2
APSL001309523R3□00	3.3	100 kHz,0.1 V	0.015	6.4	5.4	65	20	3R3
APSL001309524R7□00	4.7	100 kHz,0.1 V	0.018	5.4	4.8	45	20	4R7
APSL001309526R8□00	6.8	100 kHz,0.1 V	0.027	4.6	4.4	38	20	6R8
APSL00130952100□00	10	100 kHz,0.1 V	0.038	3.8	3.9	30	20	100
APSL00130952120□00	12	100 kHz,0.1 V	0.043	3.5	3.6	27	20	120
APSL00130952150□00	15	100 kHz,0.1 V	0.046	3	3.1	27	20	150
APSL00130952220□00	22	100 kHz,0.1 V	0.085	2.6	2.7	19	20	220
APSL00130952330□00	33	100 kHz,0.1 V	0.100	2	2.1	15	20	330
APSL00130952470□00	47	100 kHz,0.1 V	0.140	1.6	1.8	12	20	470
APSL00130952680□00	68	100 kHz,0.1 V	0.200	1.4	1.5	10	20	680
APSL00130952101□00	100	100 kHz,0.1 V	0.260	1.2	1.3	9	20	101
APSL00130952151□00	150	100 kHz,0.1 V	0.400	1	1	6	20	151
APSL00130952221□00	220	100 kHz,0.1 V	0.610	0.8	0.8	5	20	221
APSL00130952331□00	330	100 kHz,0.1 V	1.020	0.6	0.6	4.5	20	331
APSL00130952471□00	470	100 kHz,0.1 V	1.270	0.5	0.5	3.5	20	471
APSL00130952681□00	680	100 kHz,0.1 V	2.020	0.4	0.4	2.5	20	681
APSL00130952102□00	1000	100 kHz,0.1 V	3.000	0.3	0.3	2	20	102
APSL00130952152□00	1500	100 kHz,0.1 V	4.500	0.25	0.2	1.4	20	152

**Note: When ordering, please specify tolerance code. Tolerance: M=±20%**

1. Operating temperature range - 40°C ~ 125°C(Including self - temperature rise)
2. Isat for Inductance drop 20% from its value without current
3. Irms for a 40°C temprature rise from 25°C ambient with current
4. Measure Equipment:  
 L: Agilent E4980 or HP4284A  
 RDC: Chroma 16502  
 Isat: HP4284+42841A or WK3260B+WK3265B  
 SRF: HP4291A or HP4192A

**Power Inductor APSL Series**

**Automotive  
AEC-Q200**

**APSL00130952 Type**

**Characteristics Graph**

**Inductance vs. Frequency Characteristics**

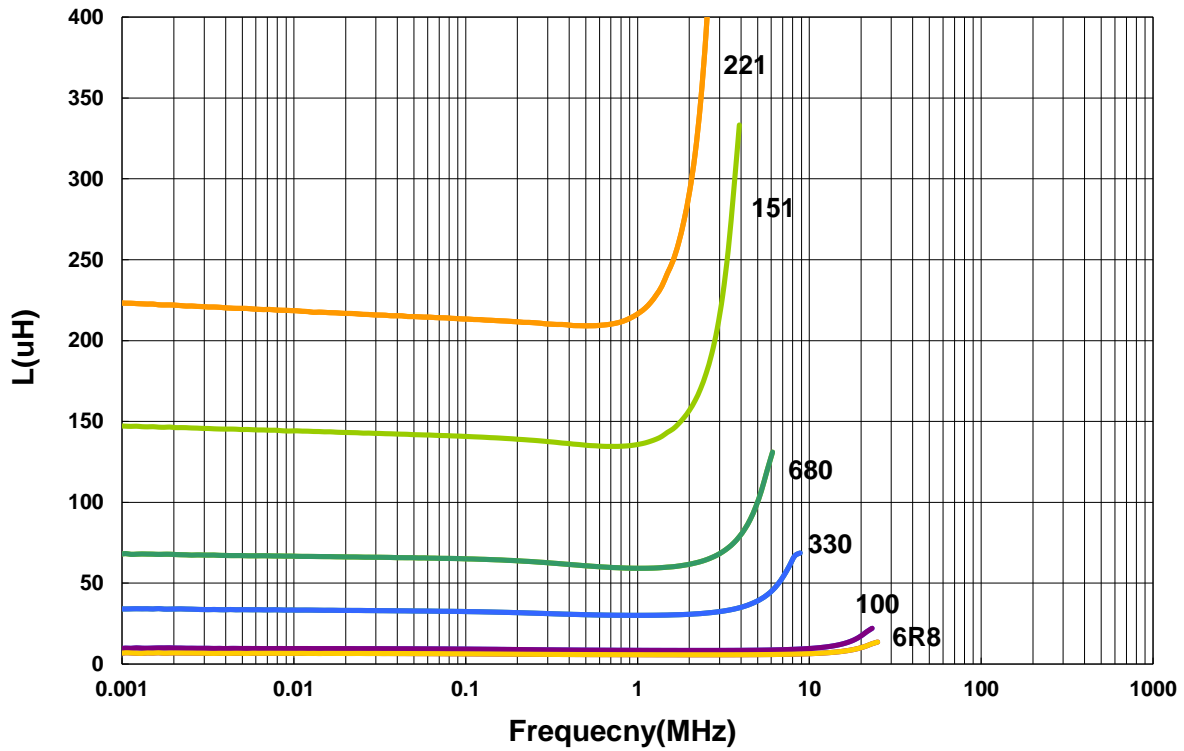

**Inductance vs. DC Current**

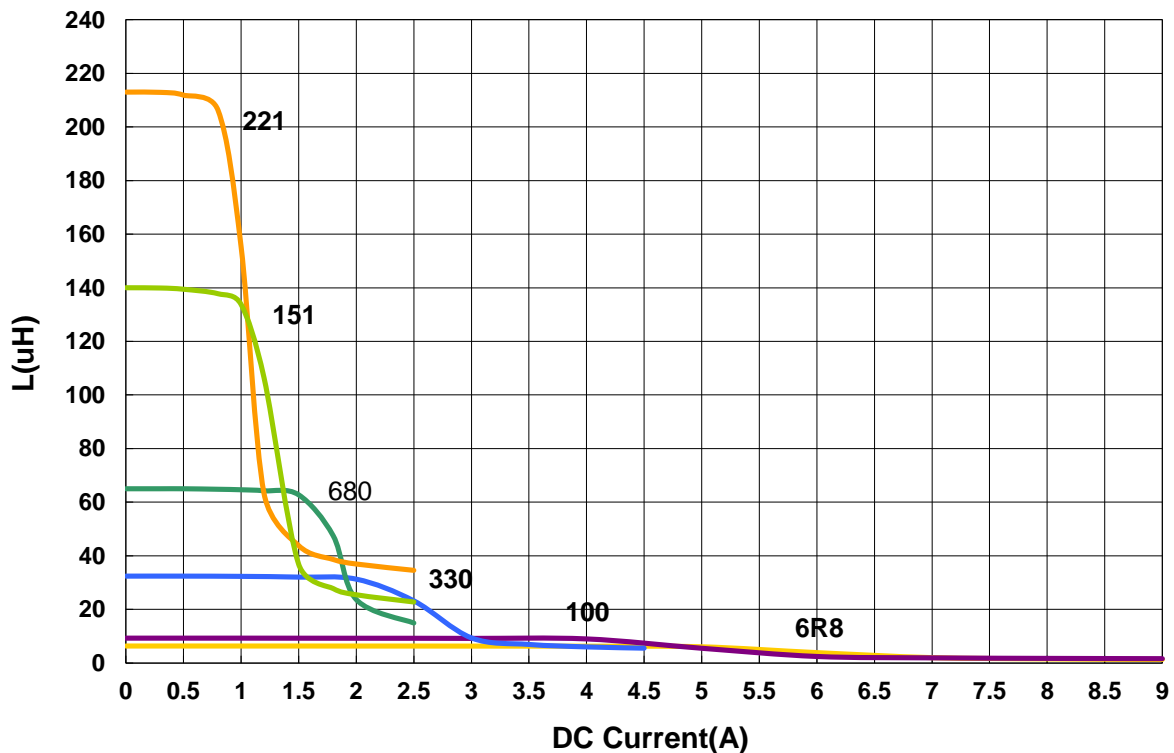

**Power Inductor APSL Series**

**Automotive  
AEC-Q200**

**APSL00130911 Type**

**■ Dimensions**

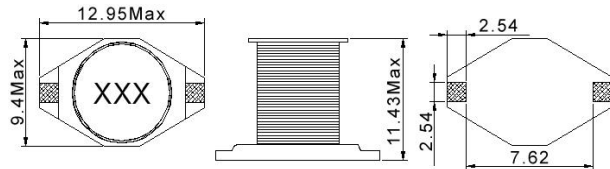

unit:mm

**■ Recommended Land Pattern**

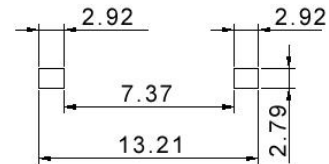

unit:mm

**■ Electrical Characteristics**

Part No.	Inductance (uH)	Test Freq.	RDC (Ω)Max.	Isat (A)	Irms (A)	SRF (MHz)Typ.	Tolerance (±%)	Marking
APSL001309112R2□00	2.2	100 kHz,0.1 V	0.007	13			20	2R2
APSL001309113R3□00	3.3	100 kHz,0.1 V	0.025	10	4	30	20	3R3
APSL001309114R7□00	4.7	100 kHz,0.1 V	0.033	8	3.5	25	20	4R7
APSL001309116R8□00	6.8	100 kHz,0.1 V	0.025	7			20	6R8
APSL00130911100□00	10	100 kHz,0.1 V	0.033	8	3.5	22	20	100
APSL00130911150□00	15	100 kHz,0.1 V	0.042	7	3	18	20	150
APSL00130911220□00	22	100 kHz,0.1 V	0.054	5.5	2.5	11	20	220
APSL00130911330□00	33	100 kHz,0.1 V	0.080	4	2	9	20	330
APSL00130911470□00	47	100 kHz,0.1 V	0.100	3.8	1.6	8	20	470
APSL00130911680□00	68	100 kHz,0.1 V	0.170	3	1.2	7	20	680
APSL00130911101□00	100	100 kHz,0.1 V	0.220	2.5	1.2	5	20	101
APSL00130911151□00	150	100 kHz,0.1 V	0.340	2	0.9	4	20	151
APSL00130911221□00	220	100 kHz,0.1 V	0.440	1.6	0.7	3.5	20	221
APSL00130911271□00	270	100 kHz,0.1 V	0.600	1.4	0.6	2.5	20	271
APSL00130911331□00	330	100 kHz,0.1 V	0.700	1.2	0.6	2.5	20	331
APSL00130911471□00	470	100 kHz,0.1 V	0.950	1	0.3	2	20	471
APSL00130911681□00	680	100 kHz,0.1 V	1.200	1	0.2	2	20	681
APSL00130911102□00	1000	100 kHz,0.1 V	2.000	0.8	0.1	1.5	20	102

**Note: When ordering, please specify tolerance code. Tolerance: M=±20%**

- Operating temperature range - 40°C ~ 125°C(Including self - temperature rise)
- Isat for Inductance drop 20% from its value without current
- Irms for a 40°C temprature rise from 25°C ambient with current
- Measure Equipment:  
 L: Agilent/ E4980 or HP4284A  
 RDC: Chroma 16502  
 Isat: HP4284+42841A or WK3260B+WK3265B  
 SRF: HP4291A or HP4192A

APSL00130911 Type

■ Characteristics Graph

Inductance vs. Frequency Charateristics

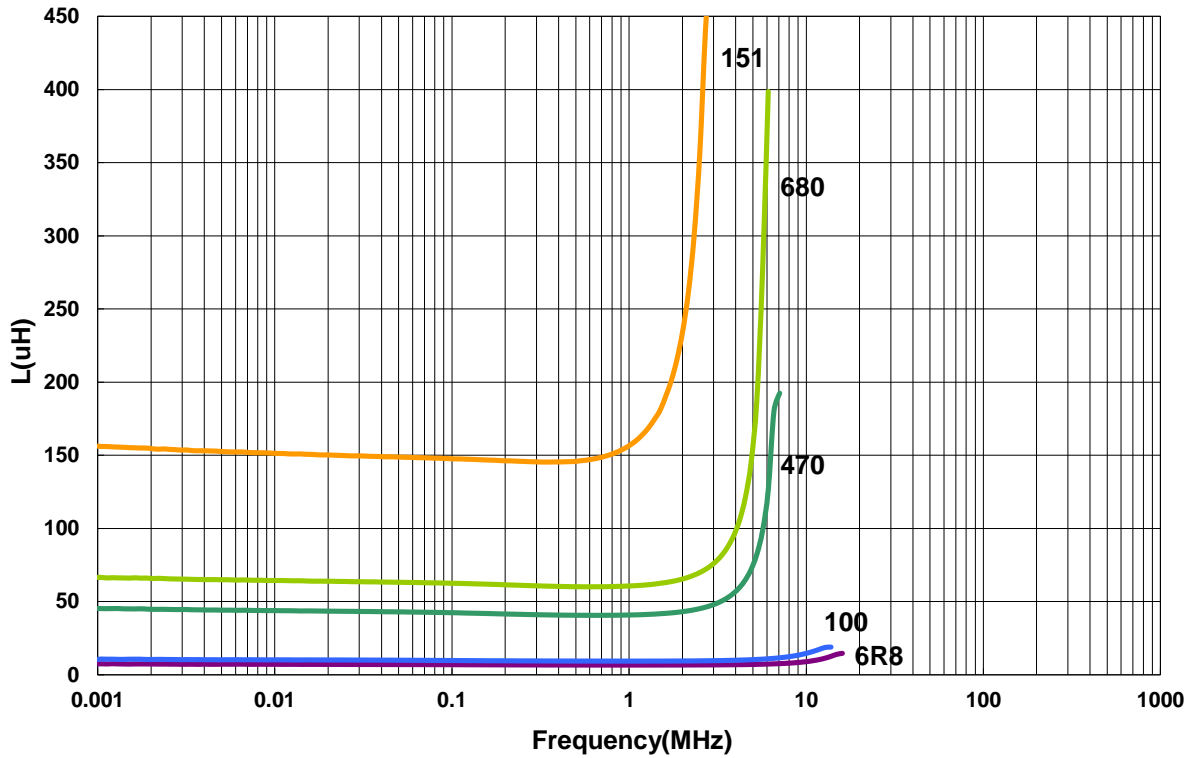

Inductance vs. DC Current

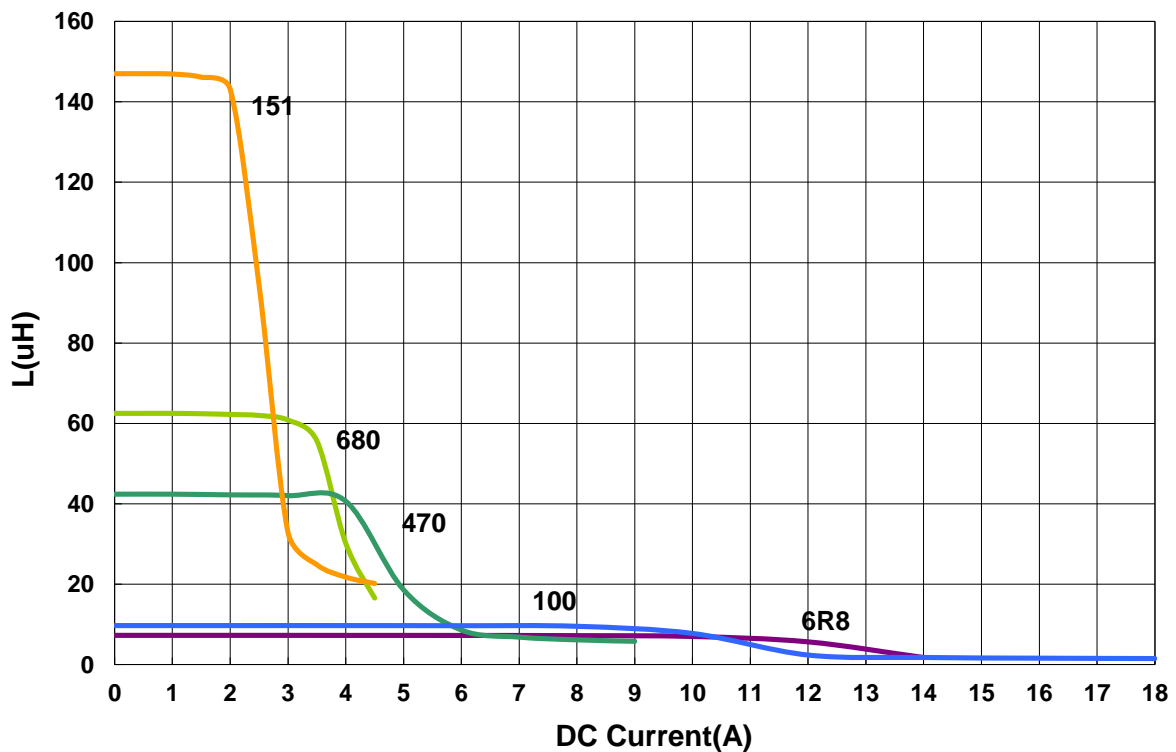

**Power Inductor APSL Series**

**Automotive  
AEC-Q200**

**■ Packaging**

Tape Dimensions

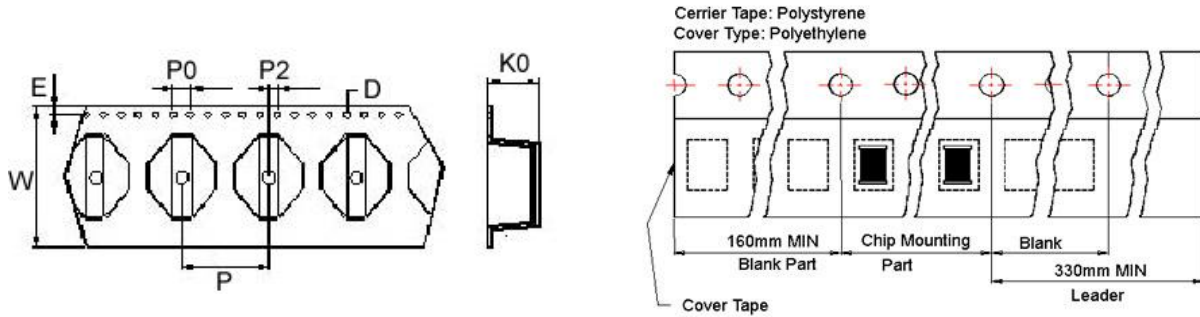

Reel Dimensions

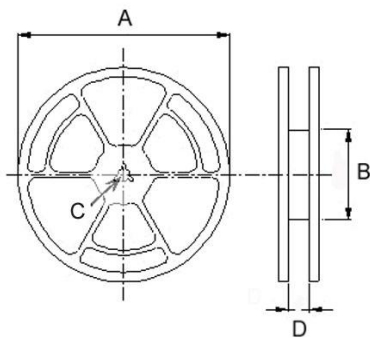

Dimensions in mm

TYPE	Tape Dimensions							Reel Dimensions				Quantity PCS / REEL
	K0	D	E	W	P	P0	P2	A	B	C	D	
APSL00130952	5.4	1.55	1.75	24	16	4	2	330	100	13	13.4	750
APSL00130911	11.5	1.55	1.75	24	20	4	2	330	100	13	13.4	225