





-  Magnetically Shielded
-  Miniature in size and high energy storage
-  Ideal for Mobilephone, PDA, MP3, DSC/DVC, Portable DVD and other DC-DC conversion applications
-  Custom inductance value or tolerance is available
-  RoHS compliant



ELECTRICAL SPECIFICATION @ 25°C

Part Number	Inductance (H)	Inductance Tolerance(%)	DCR ² (mΩ)	DC ³ Superimposition (A)	Temperature ⁴ Rise (A)	Marking (YYYY)
		N	Max			
SIS3D28LDN-100F	10	±30	92	0.50	1.52	N100
SIS3D28LDN-120F	12	±30	100	0.45	1.48	N120
SIS3D28LDN-150F	15	±30	113	0.40	1.44	N150
SIS3D28LDN-180F	18	±30	125	0.35	1.37	N180
SIS3D28LDN-220F	22	±30	146	0.33	1.28	N220
SIS3D28LDN-270F	27	±30	176	0.29	1.18	N270
SIS3D28LDN-330F	33	±30	214	0.28	1.15	N330
SIS3D28LDN-390F	39	±30	225	0.25	1.00	N390
SIS3D28LDN-470F	47	±30	304	0.23	0.81	N470
SIS3D28LDN-560F	56	±30	324	0.20	0.76	N560
SIS3D28LDN-680F	68	±30	472	0.185	0.60	N680
SIS3D28LDN-820F	82	±30	539	0.172	0.58	N820
SIS3D28LDN-101F	100	±30	608	0.160	0.52	N101
SIS3D28LDN-121F	120	±30	757	0.136	0.50	N121
SIS3D28LDN-151F	150	±30	882	0.124	0.48	N151
SIS3D28LDN-181F	180	±30	1130	0.119	0.42	N181
SIS3D28LDN-221F	220	±30	1269	0.116	0.36	N221

Notes:

1. Ordering Information: SIS3D28LDa - bbbFc.
 SIS3D28LD = Product Type.
 a = Tolerance of Inductance (N= ±30%).
 bbb = Inductance value in uH (i.e. 120 = 12uH; 121 = 120uH).
 F = Internal Control Code.
 c = Packaging Code (U = Tape & Reel Packaging in 7 inch Reel).
2. Inductance tested at 100kHz, 1Vrms.
3. It indicates the DC current value when inductance value become more than 65% of its initial value.
- 4 It indicates the DC current value when temperature rise is $t=40^{\circ}\text{C}$.
5. Operating temperature range: -40°C to $+125^{\circ}\text{C}$.
6. The part temperature (ambient temperature + temperature rise) should not exceed the upper limit of the operating temperature under worst case operating conditions. Circuit design, component placement, PWB trace size and thickness, airflow and other cooling provisions all affect the part temperature. Part temperature should be verified in the end application.

MECHANICAL DIMENSIONS

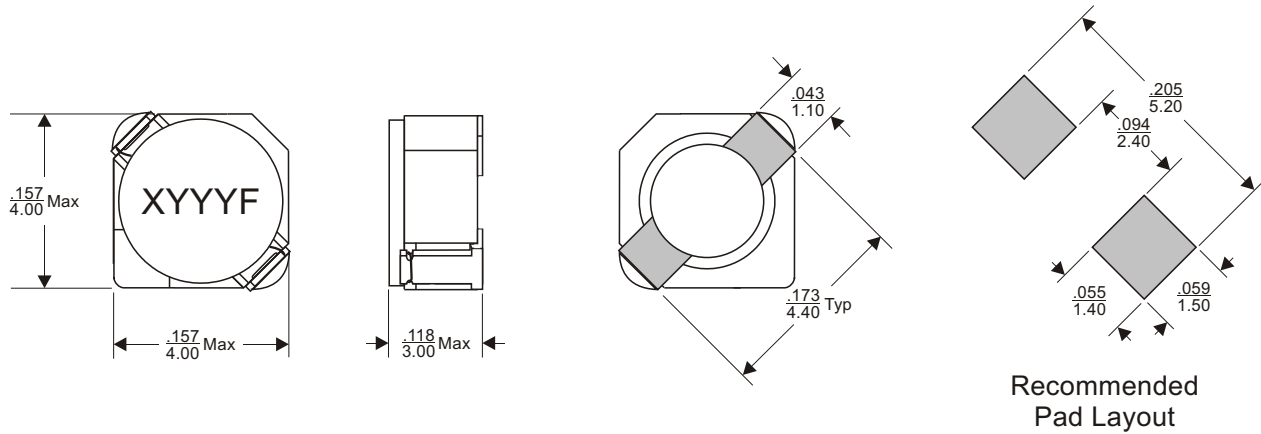

Notes:

- All dimensions are specified in $\frac{\text{inches}}{\text{mm}}$ with higher precedence in mm.
- Unless otherwise specified, all tolerances are $\pm \frac{.010}{0.25}$.

Weight (in gram)	: 0.2 typ.
Tape & Reel	: 600 / reel

SCHEMATIC

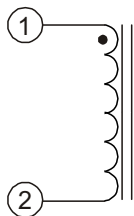

PACKAGING

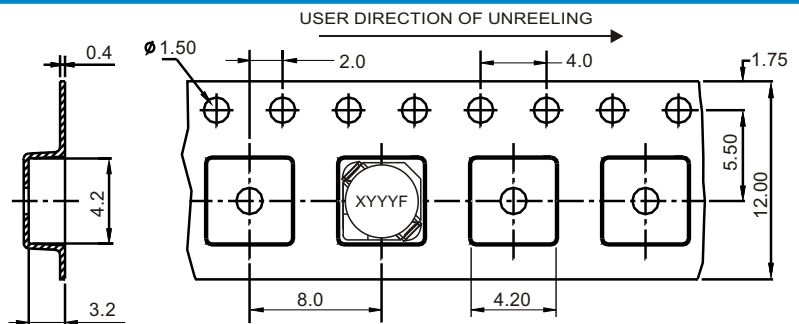

FOR MORE INFORMATION, PLEASE CONTACT

HEADQUARTER

1/F., Harbour View 1, No.12 Science Park East Avenue,
Phase II, Hong Kong Science Park, Shatin, N.T.

Hong Kong

Tel: (852) 2954 3333 Fax: (852) 2954 3304

Email: eempl@eleceltek.com

Website: <http://www.eleceltek.com> / www.eemagnetic.com

Information herein is for reference only and subject to change without notice. It does not constitute any representation, warranty or commitment of the company in respect of the products in any aspect. All logos, brands and product names mentioned herein are trademarks or registered trademarks of their respective owners. The company does not assume any liability arising out of the application or use of any product or circuit described herein. Copyrights 2009, E & E Magnetic Products Limited.